

STAGEMAKER®

small but
powerful

STAGEMAKER SM2
high power packed
into a compact model



250 kg
1 fall !

 **VERLINDE**
LIFTING EQUIPMENT

STAGEMAKER Europe - VERLINDE - 2, boulevard de l'Industrie - B.P. 20059 - 28509 Vernouillet cedex - France

Telephone :+33 (0)2 37 38 95 95 - Fax :+33 (0)2 37 38 95 99

Web site : www.stagemaker.com - E-mail : contact1@stagemaker.com

STAGEMAKER SM2 high power packed into a compact model

small but
powerful



The advantages of the SM5 in an SM1 body...

In the world of the scenic arts, the theatre, the concert hall and in exhibitions and trade shows you can now have the advantages of :

- a 250 kg load that can be lift from a single fall !
- a motor that weighs 40% less*
- compact dimensions: down by 20%*
- rotating upper hook.

light weight and small overall dimensions

TYPE	Capacity (kg)	Lifting speed (m/mn) (ft/mn)	Number of falls	Chain	Motor		A (mm)	B (mm)	H (mm)	Weight (kg/pd)
					(kW)	(hp)				
SM2 254 m1-A	250	4/16	1	4x12	0.2	0,27	334/1.97	200/7.8	110/4.3	14/30.8
SM5 254 m2-A	250	4/16	1	4.8X12.5	0.8	1	401/15.7	247/9.6	135/5.26	23/51

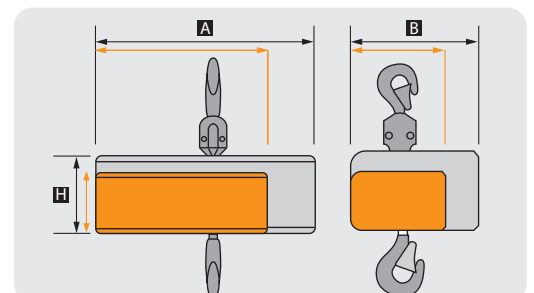

* in comparison to SM5

To locate distributor in your country, please consult : www.stagemaker.com